

SPECIFICATIONS	
FRAMES:	
CROSSMEMBER/OUTRIGGER:	1" I-BEAM w/ 1" X-WAYS @ 48" O.C.
HITCH TYPE:	8" DECKHOLE
AXLE:	TRIPLE w/ BRAKE ON (3) AXLE & 22"-6", USE 55 1/2" AXLES
TIRES:	12 PLY
MISC.:	SOLID REAR X-WAY w/ RECESSED TAIL LIGHTS
FLOORS:	
BOTTOM BOARD:	CALUMINATED STEEL
FLOOR JOISTS:	2x4, 16" O.C. (TRANSVERSE) (SPF GRADE #2)
INSULATION:	R-19 FIBROGLASS, UNFACED (R7)
CEILING:	SHINGLE LAYER, 3/4" NOMINAL, T & G PLYWOOD (SPAN RATING 24" O.C.)
COVERING:	STANDARD VINYL ROLL GOODS
MISC.:	EPDM FLOOR ADHESIVE APPLIED w/ TRIM
SEE COLOR CHART ON THIS SHEET FOR SPECIFIC COLORS	
EXTERIOR WALLS:	
FRAMING:	2x4, 16" O.C. (SPF GRADE #2)
WALL HEIGHT:	8'-0"
TOP PLATE:	DOUBLE 2x (SPF GRADE #2)
BOTTOM PLATE:	SINGLE 2x (SPF GRADE #2)
INSULATION:	R-11 FIBROGLASS, UNFACED (3 1/2")
WALL COVERING:	33" GLASSBOARD ON 1/2" WR EPSDM. (F.S. RATING CLASS I OR A (0-25))
WALL SHEATHING:	3/8" OSB
SOING:	319" ALUMINUM VERTICAL SHEETS (SMOOTH)
TRIM:	TOP STARTER: 319" ALUMINUM (RICE) w/ J-RAIL
NOTE:	PAINTED MIN-OUTER @ 500000
TRIM:	BOTTOM STARTER: 319" ALUMINUM (RICE)
TRIM:	CORNER: 319" ALUMINUM (RICE) 2-1000
NOTE:	SHIP LOCKE (1) OUTSIDE CORNER, (1) MANSARD ALUMINUM, (1) BOTTOM STARTER
SEE COLOR CHART ON THIS SHEET FOR SPECIFIC COLORS	
INTERIOR WALLS:	
FRAMING:	2x4, 16" O.C. (SPF GRADE #2)
CHASE FRAMING:	2x4, 16" O.C. (SPF GRADE #2)
WALL HEIGHT:	8'-0"
TOP PLATE:	DOUBLE 2x (SPF GRADE #2)
BOTTOM PLATE:	SINGLE 2x (SPF GRADE #2)
WALL COVERING:	33" GLASSBOARD OR 1/2" WR EPSDM. (F.S. RATING CLASS I OR A (0-25))
NOTE:	SEAL ALL WALLS @ FLOOR
SEE COLOR CHART ON THIS SHEET FOR SPECIFIC COLORS	
INTERIOR TRIM:	
WALL SEAMS:	FRP 2 PECE H-WOOD
INSIDE CORNER:	FRP J-CHANNEL
OUTSIDE CORNER:	FRP J-CHANNEL
CEILING:	FRP J-CHANNEL
BASE MOLDING:	6" VINYL CORNER BASE
SEE COLOR CHART ON THIS SHEET FOR SPECIFIC COLORS	
ROOF:	
QTY:	TRUSS: BOM, 30# LL, 16" O.C., NON-GOOD, #H054314 B/R
	TRUSS CRITERIA: 3 1/2" HEEL x 1 1/2" ROSE x 114" LONG
	INSULATION: R-19 FIBROGLASS, UNFACED
	CEILING: 1/2" WR PRE-FINISHED EPSDM. (F.S. RATING CLASS I OR A (0-25))
	NOTE: 33" FRP ABOVE SHOWERS
	SHEATHING: 3/8" OSB
	ROOFING: GALUMINATED STEEL, 30 GA
	MANSARD: 16" NOM. FLAT, ALUMINUM
6:	MISC.: TE DOWN WALL TYPE
SEE COLOR CHART ON THIS SHEET FOR SPECIFIC COLORS	
EXTERIOR DOORS:	
QTY:	2: J/D6/B
	(100) ELIJR SERIES 402 ALUMINUM FRAME w/ 10"x10" LITE w/ KEYS KNOB SET w/ DEADBOLT, GRADE 3 w/ LOCKS KEYS ALIKE w/ PRINTED ALUMINUM MIN-OUTER ABOVE DOORS 40"
SEE COLOR CHART ON THIS SHEET FOR SPECIFIC COLORS	
INTERIOR DOORS:	
QTY:	2: J/D6/B
	(516) PRE-FINISHED, HOLLOW CORE w/ PRE-FINISHED JAMB w/ FLOOR MOUNTED DOOR STOPS w/ KEYS KNOB SET, GRADE 3
SEE COLOR CHART ON THIS SHEET FOR SPECIFIC COLORS	
WINDOWS:	
QTY:	3: 30"x14"
	(A0) OSCURE GLASS, HORIZONTAL SLIDER w/ MILL FINISH FRAME w/ SCREENS
SEE COLOR CHART ON THIS SHEET FOR SPECIFIC COLORS	

QTY	DESCRIPTION	DETAIL
1	WALL	SEE COLOR CHART ON THIS SHEET FOR SPECIFIC COLORS
1	CEILING	SEE COLOR CHART ON THIS SHEET FOR SPECIFIC COLORS
1	FLOOR	SEE COLOR CHART ON THIS SHEET FOR SPECIFIC COLORS
1	ROOF	SEE COLOR CHART ON THIS SHEET FOR SPECIFIC COLORS
1	WALL	SEE COLOR CHART ON THIS SHEET FOR SPECIFIC COLORS
1	CEILING	SEE COLOR CHART ON THIS SHEET FOR SPECIFIC COLORS
1	FLOOR	SEE COLOR CHART ON THIS SHEET FOR SPECIFIC COLORS
1	ROOF	SEE COLOR CHART ON THIS SHEET FOR SPECIFIC COLORS
1	WALL	SEE COLOR CHART ON THIS SHEET FOR SPECIFIC COLORS
1	CEILING	SEE COLOR CHART ON THIS SHEET FOR SPECIFIC COLORS
1	FLOOR	SEE COLOR CHART ON THIS SHEET FOR SPECIFIC COLORS
1	ROOF	SEE COLOR CHART ON THIS SHEET FOR SPECIFIC COLORS

COLOR SELECTIONS

AREA	COLOR
FLOOR COVERING	GRAY
ROCK GOODS	GRAY
EXTERIOR	
SOUND	COLON WHITE
TOP TRIM	WY GREEN
BOTTOM TRIM	WY GREEN
CORNER TRIM	COLON WHITE
MANSARD BODY	WY GREEN
MANSARD TRIM	WY GREEN
MIN-OUTTER	WY GREEN
INTERIOR WALLS:	
COVERING	WHITE
VINYL CORN	GRAY
INTERIOR TRIM:	
INSIDE CORNER	FRP J-CHANNEL
OUTSIDE CORNER	FRP J-CHANNEL
CEILING	FRP J-CHANNEL
BASE MOLDING	6" VINYL CORNER BASE
EXTERIOR DOORS:	
DOOR	COLON WHITE

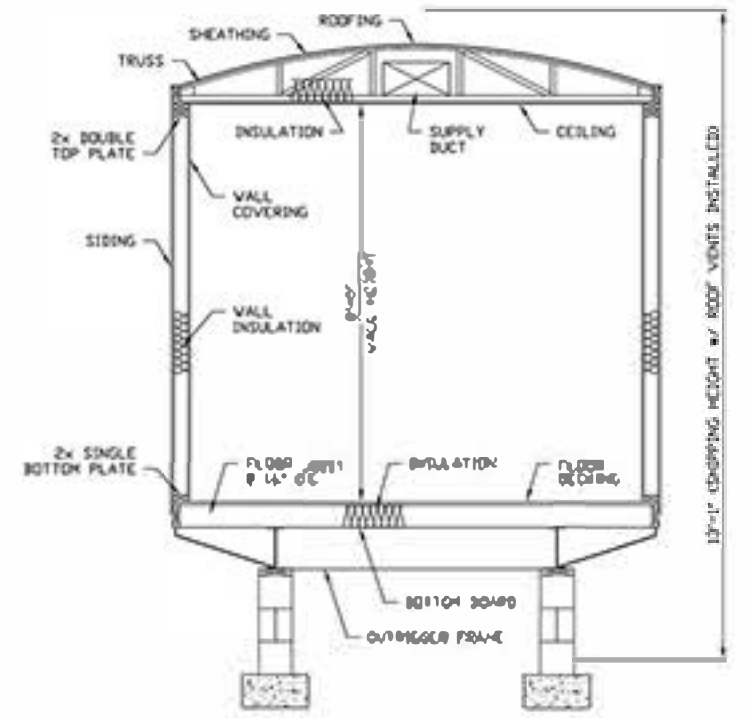

CROSS SECTION
SCALE: 1/2"=1'-0"

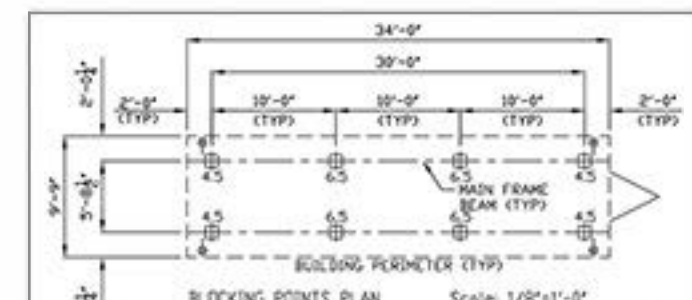

BLOCKING POINTS PLAN
Scale: 1/8"=1'-0"

- Notes:**
- 1) FAILURE TO SUPPORT THE BUILDING AT EVERY BLOCKING POINT SHOWN MAY CAUSE STRUCTURAL FAILURE.
 - 2) This is a suggested blocking plan and suggested tie down installation. The actual plans required to satisfy site conditions shall be performed by a registered engineer or architect. Mark Line Industries, Inc. assumes no responsibility for foundation design and construction.
 - 3) Piers in exit areas may cause removal of spring hangers on I-beams.
 - 4) Ⓞ denotes frame tie down locations. Tie downs to be within 2' of a pier. Tie downs and components rated # 205R min. furnished and installed by site contractor.
 - 5) Masonry unit piers in accordance with local authority.
 - 6) Overall module & building dimensions are measured to outside face of wall framing. Width of projections & thickness of sheathing and siding are not included in these dimensions.
 - 7) Loads are in 1000 lbs.
 - 8) Loads based upon Roof Live Load of 30 psf, Floor Live Load of 50 psf and Building Dead load of 53 psf.

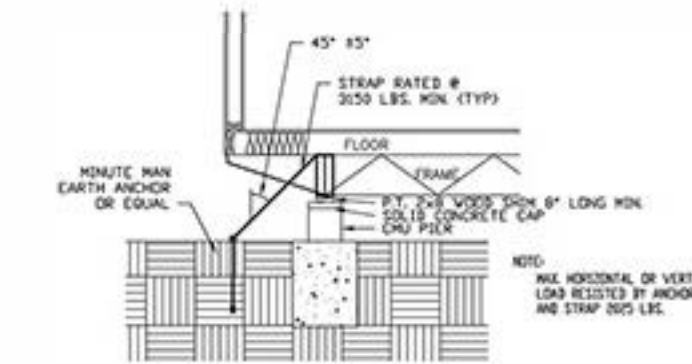

TIE DOWN DETAIL
SCALE: 1/2"=1'-0"

PE SEALS:

ALL ITEMS THAT ARE CLOUDED ARE FIELD INSTALLED

REV	DESCRIPTION	DATE	BY
10/28/10	TV	10/28/10	TV

DEAR JOHN TRAILER SALES	PROJECT NAME: 10AMR/SHOWER	PLANT LOCATION: BRISTOL IN
MODEL: 1038	DATE: 10/20/10	DRAWN BY: AM
DRAWING SCALE: AS NOTED	QUOTE NO.:	SERIAL NO.:
GTE00008291-A	IN-037545	DRAWING NUMBER: S1