

## NOTE:

The ID number is not intended to identify a specific circuit breaker or location inside the load center but to identify like circuits only. Circuits shall be balanced between phases as near as possible in accordance with N.E.C. Section 250.

## WIRING SIZES

15 amp circuits #14 copper\*\*      45 amp circuits #8 copper\*\*  
 20 amp circuits #12 copper\*\*      50 amp circuits #8 copper\*\*  
 25 amp circuits #10 copper\*\*      60 amp circuits #6 copper\*\*  
 30 amp circuits #10 copper\*\*      90 amp circuits #3 copper\*\*  
 40 amp circuits #8 copper\*\*      110 amp circuits #2 copper\*\*

\*\* 75°C min. temperature rating with equipment terminations listed and identified for 75°C. Type THW or THWN.

\*\* Type NM cable (from 60" column table 310-16).

## PANEL

## ELECTRICAL LOAD CALCULATIONS

ID	AMPS/ VOLTS	DESCRIPTION	CONNECTED LOAD	DEMAND LOAD	FACTOR	TOTAL LOAD
1	15/1	LIGHTS	844.75=159	224.15		
2	15/1	RECEPTS	5180-900	784	1.25	980
3	25/1	BASEBOARD HEATER	2*1000=2000		1.75	3500
4	15/1	AC	940		1.00	940
TOTAL LOAD OF UNIT						5,320
WATTS / VOLTS = AMPS						
VOLTS X AMPS = WATTS						
FOR 3 PHASE $\frac{V}{\sqrt{3}}$						
F.L.A. = $\frac{5,320}{240V} = 22$ AMPS						

## TOTAL LOAD OF UNIT

5,320

WATTS / VOLTS = AMPS

F.L.A. =  $\frac{5,320}{240V} = 22$  AMPS

VOLTS X AMPS = WATTS

240V.

FOR 3 PHASE  $\frac{V}{\sqrt{3}}$ 

SYMBOL	DESCRIPTION
▼	TIE DOWN, WALL TYPE
V	SINGLE GANG J-BOX W/1/8" CONDUIT THRU FLOOR FOR COMPUTER & TELEPHONE, 36" AFF
T	THERMOSTAT, 48" AFF
□	4" 2KW BASEBOARD HEATER
\$	120 V., 15 AMP, TOGGLE TYPE SWITCH 48" AFF
⊕	180 V., 15 AMP, A/C RECEPT
⊖	120 V., 15 A., DUPLEX RECEPT 80" AFF (UNLESS NOTED)
○	CEILING MOUNTED INCANDESCENT LIGHT
—	4" DOUBLE TUBE SURFACE MOUNTED FLOOR STRIP LIGHT
⊕	LOAD CENTER

## DRAWING LEGEND

MARK	DESCRIPTION
AC10	8000 BTU G.E. THRU WALL A/C SLEEVE ONLY R.S. 25 1/4" X 18" X 52" AFF
AD	2014 ALUMINUM WINDOW R.S. 30 1/4" X 14 1/4", 54 1/2" AFF
FH	3027 HORIZONTAL SLIDER WINDOW R.S. 30 1/4" X 27 1/4", 41 1/4" AFF
515	2400 INT PREFINISHED A.C. DOOR w/PREFINISHED JAMB R.S. 25 3/4" X 80"
306	6070 STEEL HELL UP GARAGE DOOR R.S. 80" X 70"
100	5680 EXTERIOR ALUMINUM DOOR R.S. 36 1/4" X 80"

## OPENING SCHEDULE

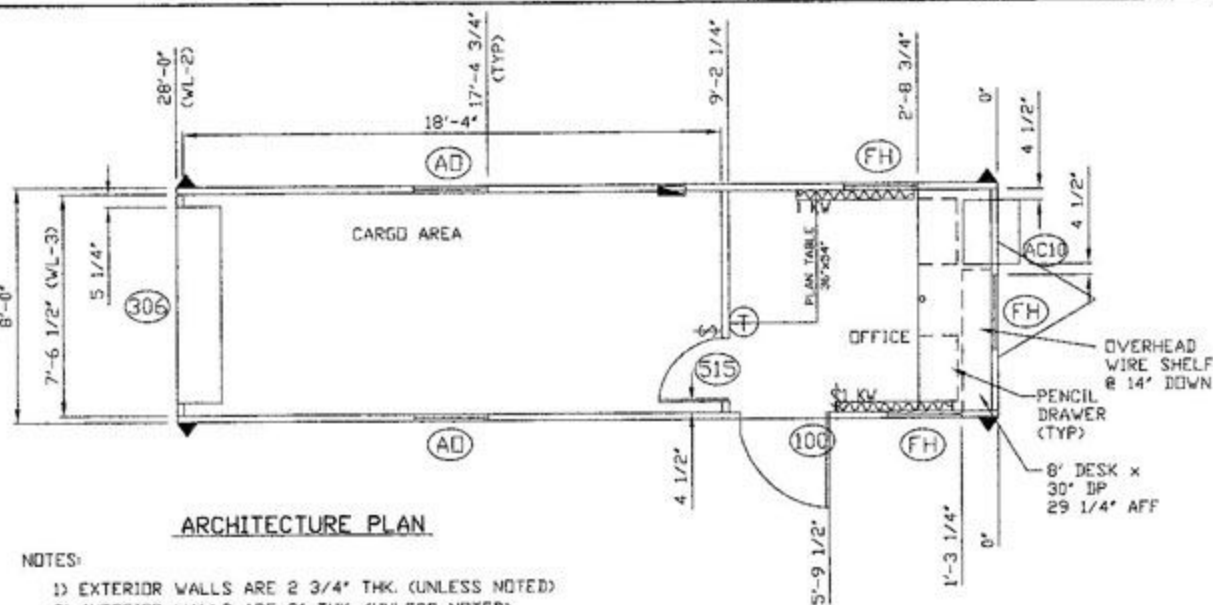

## ARCHITECTURE PLAN

## NOTES:

- 1) EXTERIOR WALLS ARE 2 3/4" THK. (UNLESS NOTED)
- 2) INTERIOR WALLS ARE 3" THK. (UNLESS NOTED)

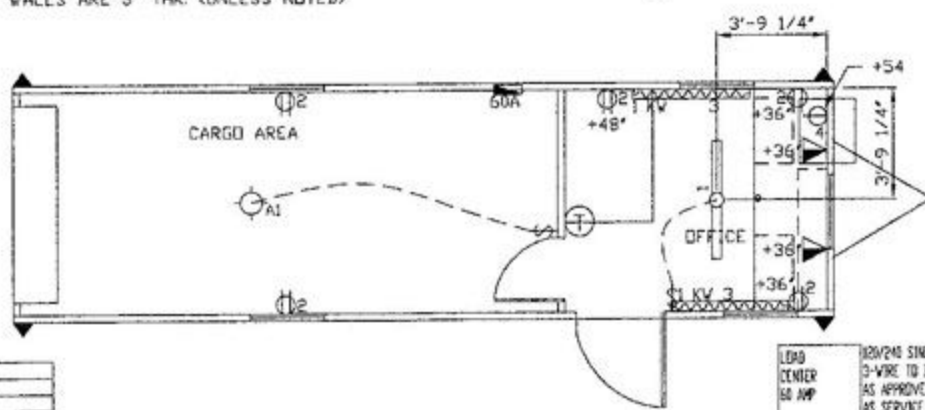

## ELECTRICAL/HVAC PLAN

88 GROUNDING ELECTRODE IN ACCORDANCE WITH N.E.C. ARTICLE 250

LEAD CENTER 60 AMP  
 100/240 SINGLE PHASE 3-WIRE TO BE MARKED AS APPROVED FOR USE AS SERVICE EQUIPMENT  
 1 1/4" ELECTRICAL PVC w/SEPARATE GROUND OR 1 1/4" EMT CONDUIT STUBBED THRU FLOOR FOR 3-#4 THW  
 SERVICE AT SITE BY SITE CONTRACTOR