

NOTE

The ID number is not intended to identify a specific circuit breaker or location inside the load center but to identify like circuits only. Circuits shall be balanced between phases as near as possible in accordance with NEC Section 205.

WIRING SIZES

15 amp circuits #14 copper** 45 amp circuits #8 copper**
 20 amp circuits #12 copper** 50 amp circuits #6 copper**
 25 amp circuits #10 copper** 60 amp circuits #5 copper**
 30 amp circuits #10 copper** 90 amp circuits #3 copper**
 40 amp circuits #8 copper** or ** 115 amp circuits #2 copper**

** 75°C min. temperature rating with equipment terminations listed and identified for 75°C. Type THW or THWN.

** Type NH cable (from 61" column table 310-16).

ELECTRICAL LOAD CALCULATIONS				
ID NO./POLES	DESCRIPTION	CONNECTED LOAD	CALCULATED LOAD	TOTAL LOAD
1 15/1	LIGHTS	84+75=159	249	1050
2 15/1	RECEPTS	5*15=90	90	900
3 25/1	BASEBOARD HEATER	2*1000=2000	2000	2,500
4 15/1	AC	940	940	940
TOTAL LOAD OF UNIT				5,390
WATTS / VOLTS = AMPS				
VOLTS X AMPS = WATTS				
FOR 3 PHASE $\frac{W}{\sqrt{3} \times V}$				
FLA = $\frac{5,390}{240} =$				23 AMPS

SYMBOL	DESCRIPTION
▽	TIE DOWN WALL TYPE
V	SINGLE GANG J-BOX W/1/2" CONDUIT THRU FLOOR FOR COMPUTER & TELEPHONE, 36" AFF
⊕	THERMOSTAT, 48" AFF
▬	4" 1KV BASEBOARD HEATER
⊥	120 V., 15 AMP, TOGGLE TYPE SWITCH 48" AFF
⊙	120 V., 15 AMP, A/C RECEPT
⊕	120 V., 15 A., DUPLEX RECEPT 18" AFF UNLESS NOTED
○	CEILING MOUNTED INCANDESCENT LIGHT
—	4" DOUBLE TUBE SURFACE MOUNTED FLOOR STOP LIGHT
⊕	LOAD CENTER

MARK	DESCRIPTION
AC10	6000 BTU GE. THRU WALL A/C SLEEVE ONLY R.D. 26 1/4"x36 3/8", 63" AFF
AD	3064 OBSOLETE WINDOW R.D. 30 1/4"x28 1/4", 34 1/2" AFF
FH	2007 HORIZONTAL SLEEK WINDOW R.D. 30 1/4"x27 1/4", 41 3/4" AFF
S15	2486 301 PREFINISHED HC. DOOR w/PREFINISHED JAMB R.D. 25 3/4" X 80"
306	6570 STEEL ROLL UP GARAGE DOOR R.D. 80"x50"
100	2640 EXTERIOR ALUMINUM DOOR R.D. 36 1/4"x60"

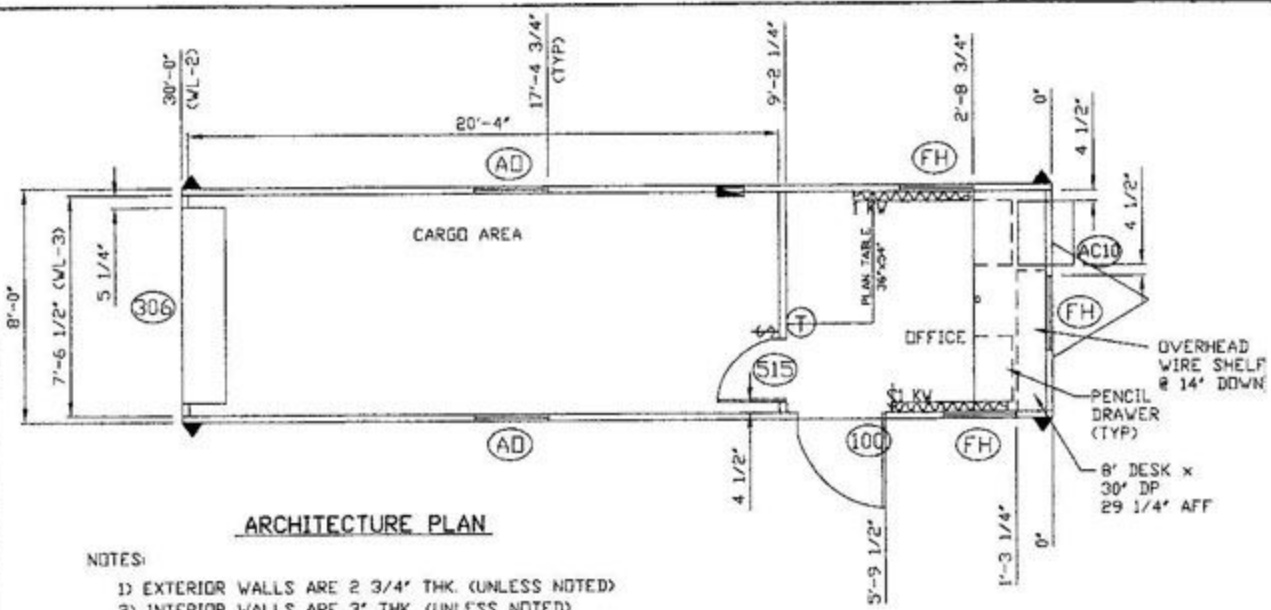

ARCHITECTURE PLAN

- NOTES:**
- 1) EXTERIOR WALLS ARE 2 3/4" THK. (UNLESS NOTED)
 - 2) INTERIOR WALLS ARE 3" THK. (UNLESS NOTED)

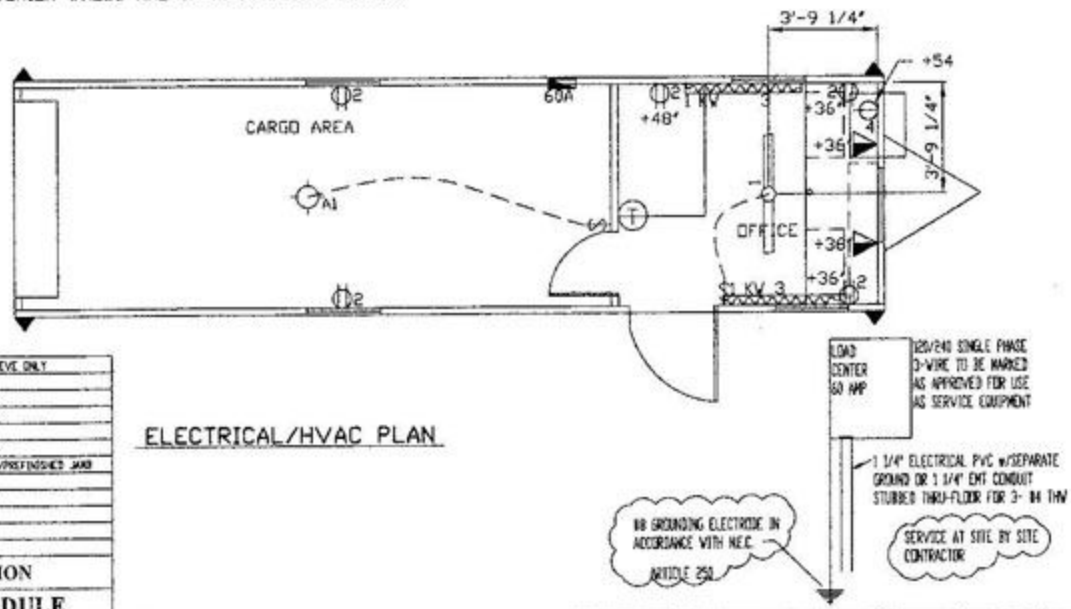

ELECTRICAL/HVAC PLAN

DRAWING LEGEND

OPENING SCHEDULE